



YY-02xx Cube Case Technical Instruction

I. INTRODUCTION

1. This Cabinet

YY-02XX is a server cabinet configured on PS2 power supply or a PS2 sized redundant power supply which takes using as a Server/Raid system. Compatibility of full size AT, Baby AT, ATX motherboard. The chassis is not allowing the height of Xeon retainion.

2. Component Checklist

If assembling this chassis by yourself, it is important to prepare all the chassis components before starting. This will save a great deal of time by not having to hunt down components. The following checklist provides a guideline as to the necessary components for a chassis.

Standard Components

- ✓ Chassis YY-0210/YY-0221
- ✓ Power Supply PS2 PSU or Mini Redundant PSU

Optional required Components

- ✓ Cooling Fan 9cm cooling fan, 1pce
- ✓ Cooling Fan 8cm cooling fan, supports up to 2pcs
- ✓ EMI Filter EMI filter for tail gates
- ✓ I/O Shield Various I/O shield



II. System Assembly and Disassembly

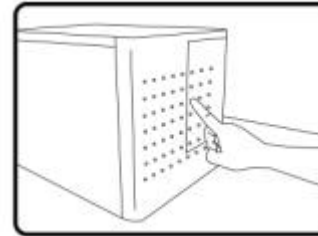

1. Front Panel

Push the door (pointed) to open the door for devices' operation.

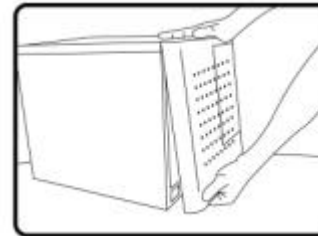

To assembly the front panel with plugging two hooks of the bottom of front panel, into the chassis body and snaps the springs of front panel in.



2. Side Panels

There are two screws in each side, release the screws, and open it like a door.

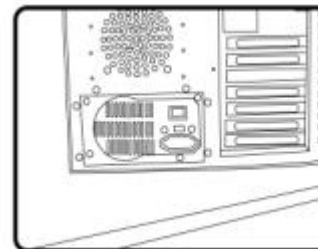

3. Power Supply Mounting

The chassis allows PS2 power supply with bracket or mini redundant power supply. Four screws are used to secure the power supply to the cabinet backside.

4. Install Storage Devices

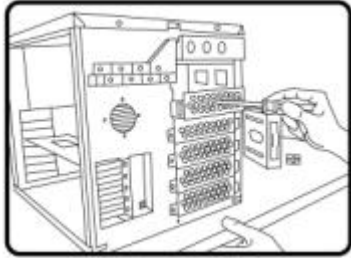

To install 5.25" HDD or CD-ROM, it should release the 5.25" device frame from the cabinet body first.

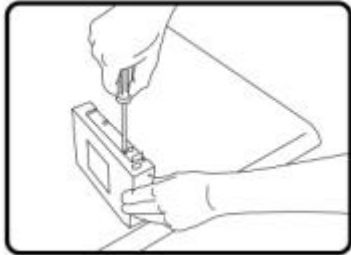

Take the metal slides out from 5.25" device frame, and ensure the metal slides should be fitted with device in position.

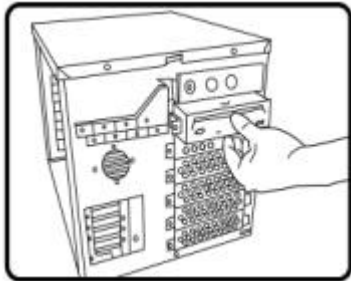

Press the device inward, to take the slides in along the rails of drive bay. Fasten by (2) screws on front side.

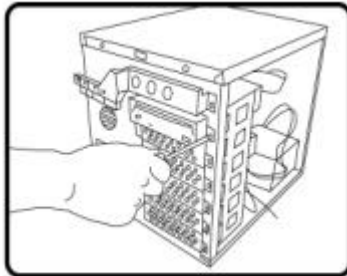

To install 3.5" HDD in the 5.25" drive bay, the metal shield could be screwed in the front end for better EMI result.

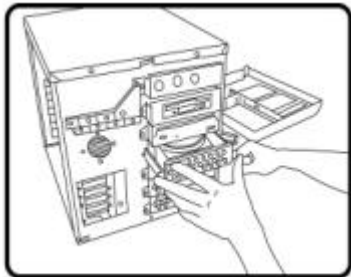

5. Install motherboard & add-on-cards

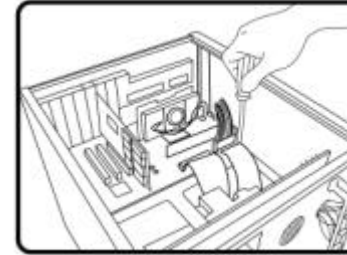

Install I/O shield (putting from inside of case).

Finding correct mounting hole for M/B, screw in standoffs. Fasten M/B with the screw. Install add-on-cards.

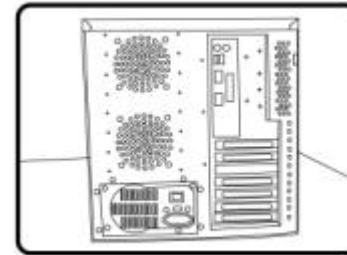

6. Cooling Fan mounting

Front mounted: Fasten 9cm fan from outside of chassis by screw.

Rear mounted: Fasten 8cm fans from outside of chassis by screws.

7. Routing cables

8. Close the chassis

Close the door. Snap in front panel without screw.